



TRINITY - THE PLACE TO BE | trinity-group.com



Lansdowne Live 2.0

1015 Bank St, Ottawa, ON

Lansdowne Live 2.0 offers a rare opportunity to add highly curated retail, sports & entertainment, and residential density to an iconic development in the heart of Ottawa's Glebe District. Lansdowne Live 2.0 includes a redevelopment of the north side stands of TD Place, with two residential towers to rise up from the commercial podium overlooking the Rideau Canal. With history, community, and innovation at its core, the redevelopment will complement the existing commercial mix by introducing an additional 44,779 SF of highly active retail over two levels, a 5,500-seat ice hockey arena, 772 rental and condo units, and potential for a new state of the art music venue.

World renowned restaurants and retail establishments will thrive in this high energy location supported by strong demographics in the Glebe. Around the clock, Lansdowne Live attracts individuals from all walks of life, young to old, who will continue to take full advantage of the amenities, making it a perfect flagship retail location. With Phase 1 estimated to start construction mid-2024, Lansdowne Live is set to harness its full potential as a premium, one of a kind, eat, shop and play destination.

Demographics	1 km	3 km	5 km
Total Population	14,615	111,174	261,355
Number of Households	5,956	57,358	128,721
Average Household Income	\$169,462	\$101,639	\$94,043
Median Age	42.1	35.4	37.2

Lansdowne Live 2.0

1015 Bank St, Ottawa, ON

Location

Northeast Corner of Bank Street &
Queen Elizabeth Drive (at the Rideau Canal)

Size

Existing Retail	340,000 s.f.
Future Retail	44,800 s.f.
Existing Residential (280 units)	224,000 s.f.
Future Residential (772 units)	600,000 s.f.
Existing Office	116,000 s.f.
Future Entertainment	28,000 s.f.

Underground Parking

1,430 parking spaces.

Redevelopment Estimated Completion

New Hockey Rink	Q4 2026
Additional Retail and Residential	Q4 2030

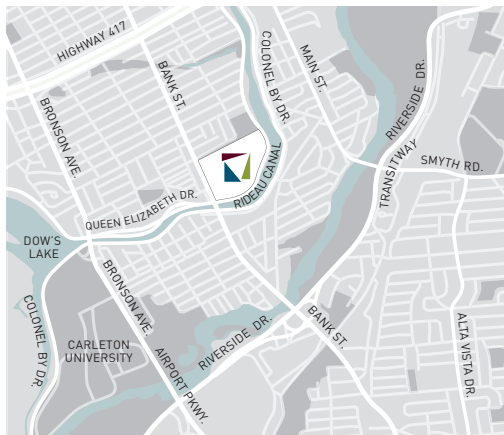

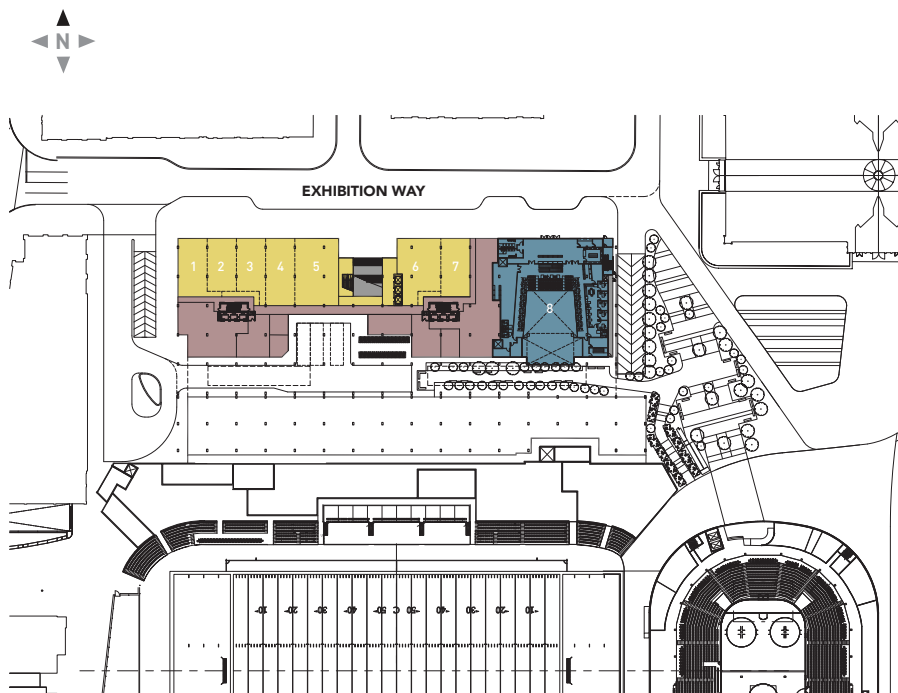

LEVEL 1

Tenants

- | | |
|-------------------------|------------------------------------|
| 1. Available 2,531 s.f. | 5. Available 2,018 s.f. |
| 2. Available 2,018 s.f. | 6. Available 4,251 s.f. |
| 3. Available 2,018 s.f. | 7. Available 2,342 s.f. |
| 4. Available 2,018 s.f. | 8. Entertainment Venue 27,617 s.f. |

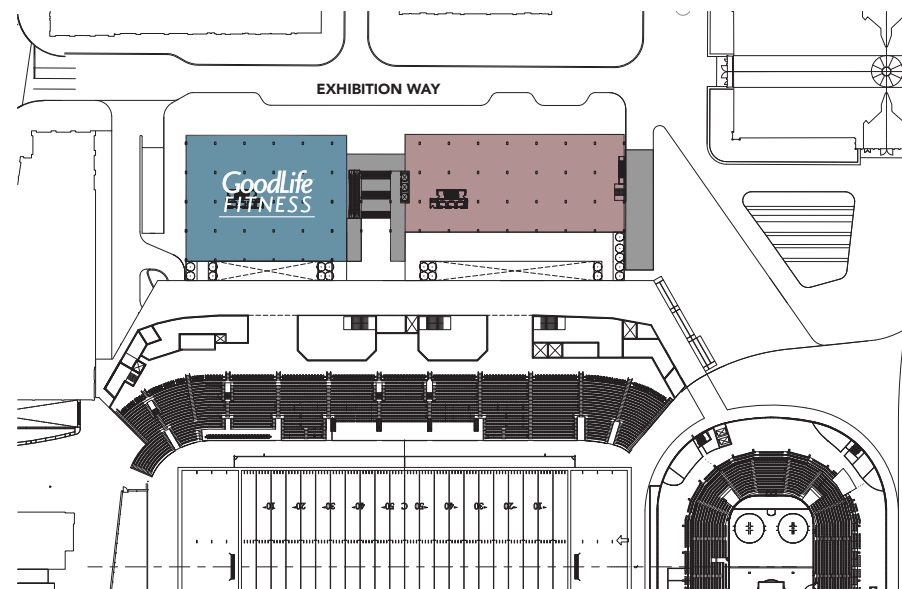

LEVEL 2

Tenants

Goodlife Fitness

- Retail Leased
- Retail Available
- Residential

Lansdowne Live 2.0

1015 Bank St, Ottawa, ON



TRINITY - THE PLACE TO BE | 2024
trinity-group.com

77 Bloor Street West, Suite 1601
Toronto, ON Canada M5S 1M2
t: 416.255.8800 f: 416.255.8355

979 Bank Street, Suite 209
Ottawa, ON Canada K1S 5K5
t: 613.565.5864 f: 613.565.6380

